

1. Contents and assembly

Package contents:

1. **Stand body** x1
2. **Wheel holder** x1
3. **Left and right leg** x2
4. **M8 washer** x6
5. **Nut cap** x6
6. **M8 nut** x6
7. **Split pin** x2
8. **Locking pin** x1
9. **M8*46mm screw** x6
10. **Axle** x1
11. **Wrench 13** x1
12. **Allen key 5** x1

Assembly:

The paddock stand is delivered disassembled and some very basic assembly is required. Follow the blueprint to attach the **left and right legs**(3) of the stand to the **stand body**(1) using the included **washers**(4), **nuts**(6), **M8 screws**(9) and **nut caps**(5).

Once attached place the **wheel holder**(2) and insert the **axle**(10) and secure it with **split pins**(7) on both sides.

Insert and remove the **locking pin**(8) during the use as needed.

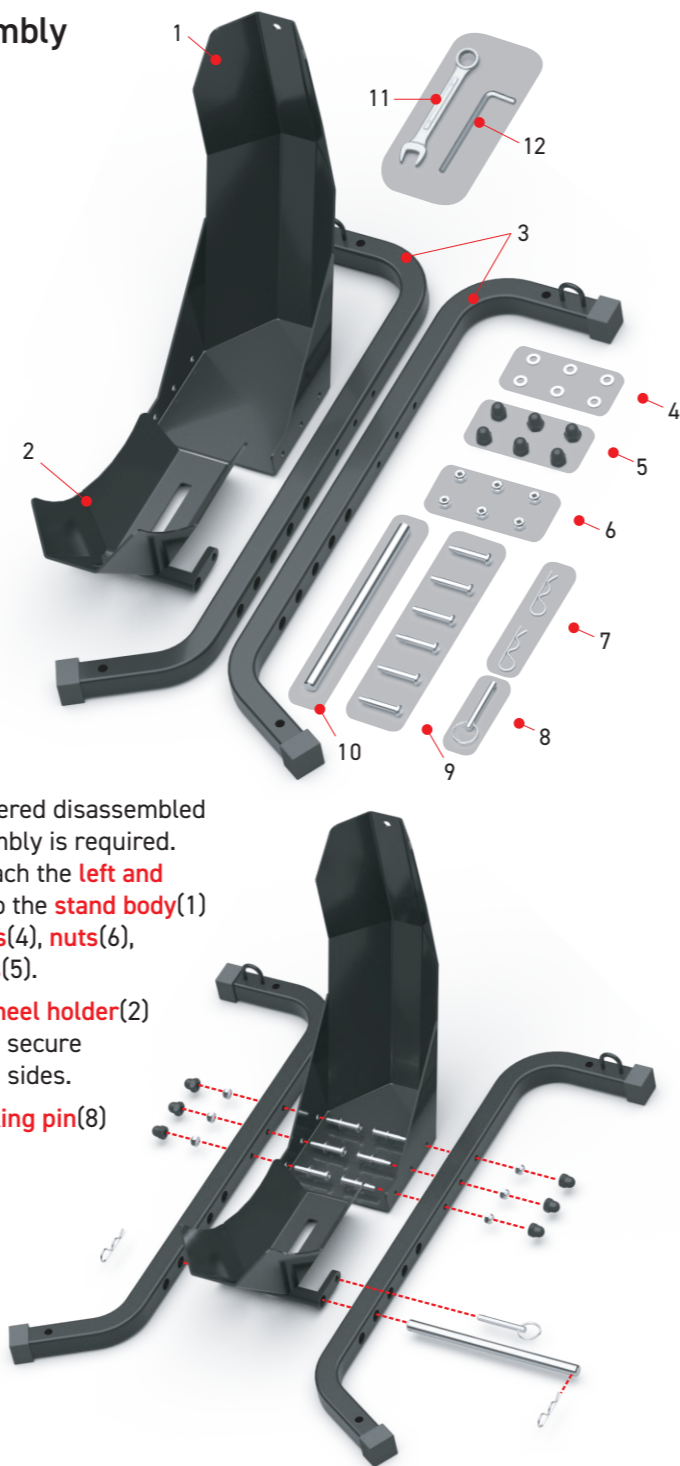

2. Use of the motorcycle transport stand C21

Place the transport stand at the transport location and adjust the **wheel holder**(2) position as described in the assembly to fit the front wheel size of the transported motorcycle.

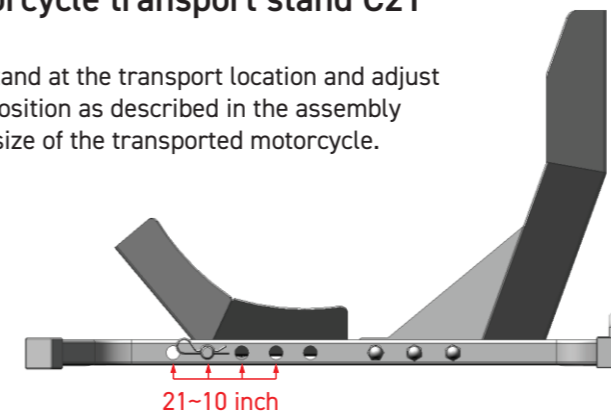

Once set up drive the front wheel of the motorcycle into the transport stand which will flip the wheel holder to hold the wheel. Do not forget to secure it with the **locking pin**(8) afterwards.



3. Warning

It is necessary to secure the motorcycle during the transport. Transporting unsecured motorcycle might result in damage to the motorcycle, the transport stand, transporting vehicle or injury of the driver or the passengers. We recommend always securing the motorcycle using ratchet straps attached to the transport vehicle.

The transport stand C21 can also be attached to the floor of the transport vehicle permanently using the mounting holes in the **left and right leg**(3) of the stand. Once the transport stand is firmly attached to the vehicle the strap loops on the legs of the stand can also be used to secure the motorcycle during transport.

Prior to the use always inspect technical condition of the transport stand. Keep out of reach of children.

