

# BIND CHARGE CHARGING MODULE FOR BIND PHONE HOLDER



## CHARGING MODULE FUNCTIONS

The BIND CHARGE charging module is an optional extension for the M-Style phone holder BIND. The module can be used for phones with cable and wireless charging. For charging with a cable, a USB-C socket with a power of 36W is located on the body of the charger. It also includes additional module for wireless charging, which installs directly on the body of the holder and provides fast 15W charging using universal Qi technology. The charging module is water and dust resistant with IP66 certification.

This module is designed specifically for the BIND holder and is not compatible with other phone holders.

The module does not include a phone holder, which is being sold separately.

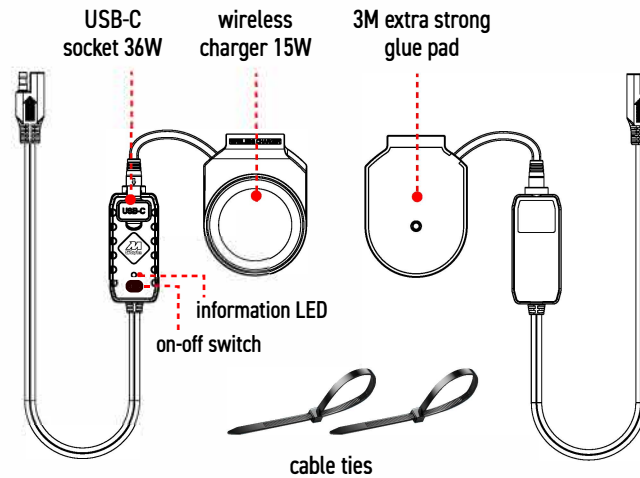

## CHARGING MODULE INSTALLATION

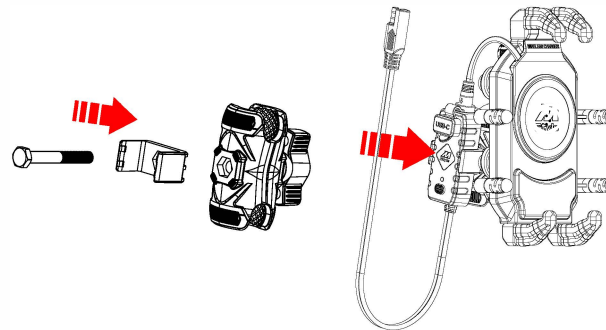

1. Use screw and plastic clamp from charge module packaging and attach the clamp to BIND phone holder locking clamp.

2. Push the body of the charge module into the clamp until it clicks in.

## WIRELESS MODULE INSTALLATION

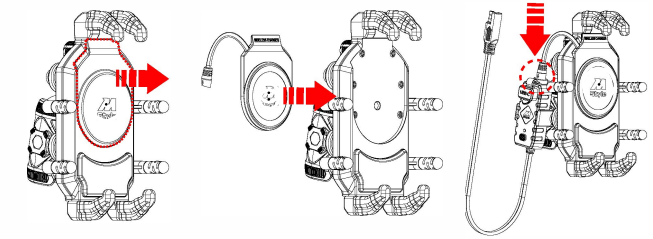

1. Remove the rubber insert glued in the upper part of the BIND phone holder body.

2. Remove the cover film from the glue pad on the rear side of the wireless module and glue it in.

3. Attach the cable from the wireless module into socket at top of the charging module.

## CONNECTING TO THE BATTERY

1. Run the long cable of the module to the motorcycle battery. We recommend to route the cable together with the other cabling and to secure it with cable ties. The cable ends with eyelets for easy installation directly under the battery contact screws. The plus positive cable is marked in red.

Alternatively, it is possible to connect the plus red cable to key switch box.

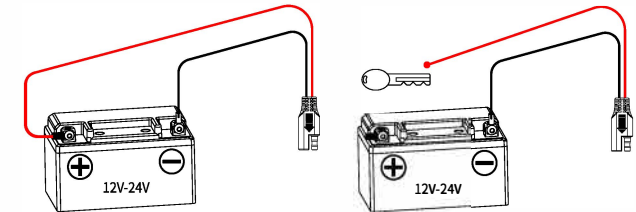

2. Connect the connector of the cable leading from the battery with the connector from the charging module.

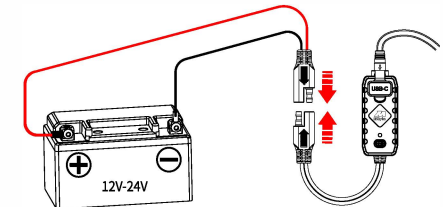

## TECHNICAL DATA

wireless charging: Qualcomm 3.0 Qi 15/10/7.5/5 W  
 USB-C socket: 36W, 5V/3.5A, 9V/3.5A, 12V/3A  
 compatibility: DC 12 - 24V / 3A max  
 use temperature: -10°C - 48°C  
 certifications: CE, FC, RoHS, IP 66

